

ZETA 230 ZETA 260 ZETA 300

max. 228 l/min - 61 GPM · 20 bar - 290 PSI · 550 RPM max. 256 l/min - 68 GPM · 20 bar - 290 PSI · 550 RPM max. 295 l/min - 78 GPM · 20 bar - 290 PSI · 550 RPM

TS 2C ZETA 230 cod. 849900
ZETA 260 cod. 849800
ZETA 300 cod. 849600

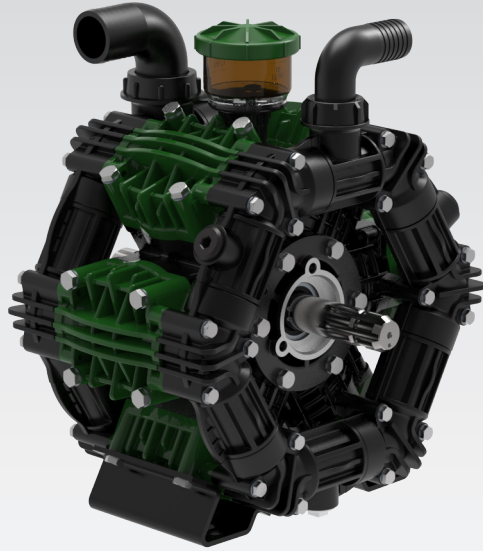

Membrane **GREENTECH** di serie
GREENTECH diaphragm as standard
cod. 090361

MOD.	RPM	0 bar / 0 PSI				5 bar / 72 PSI				10 bar / 145 PSI				15 bar / 217 PSI				20 bar / 290 PSI				Peso Weight	
		Portata Flow rate		Potenza Power		Portata Flow rate		Potenza Power		Portata Flow rate		Potenza Power		Portata Flow rate		Potenza Power		Portata Flow rate		Potenza Power			
		l/min	GPM	HP	kW	l/min	GPM	HP	kW	l/min	GPM	HP	kW	l/min	GPM	HP	kW	l/min	GPM	HP	kW	Kg	lb
ZETA 230	400	169.5	44.8	1.7	1.2	164.1	43.4	2.1	1.5	162.8	43.0	4.2	3.1	161.6	42.7	6.2	4.6	160.5	42.4	8.2	6.0	36.0	79.4
	450	189.0	49.9	1.9	1.4	183.6	48.5	2.4	1.7	182.3	48.2	4.7	3.4	181.1	47.8	7.0	5.1	180.0	47.6	9.2	6.8		
	500	208.5	55.1	2.1	1.5	203.1	53.7	2.6	1.9	201.6	53.3	5.2	3.8	200.6	53.0	7.7	5.7	199.5	52.7	10.2	7.5		
	550	228.0	61.0	2.3	1.7	222.6	58.8	2.9	2.1	221.3	58.5	5.7	4.2	220.1	58.2	8.5	6.2	219.0	57.9	11.2	8.3		
ZETA 260	400	190.9	50.4	1.9	1.4	185.5	49.0	2.4	1.7	184.2	48.7	4.7	3.5	183.0	48.3	7.0	5.2	181.9	48.1	9.3	6.9	36.0	79.4
	450	212.6	56.2	2.1	1.6	207.2	54.7	2.7	2.0	205.9	54.4	5.3	3.9	204.7	54.1	7.9	5.8	203.6	53.8	10.4	7.7		
	500	234.3	61.9	2.3	1.7	228.9	60.5	2.9	2.2	227.6	60.1	5.8	4.3	226.4	59.8	8.7	6.4	225.3	59.5	11.6	8.5		
	550	256.0	68.0	2.6	1.9	250.6	66.2	3.2	2.4	249.3	65.9	6.4	4.7	248.1	65.5	9.5	7.0	247.0	65.3	12.7	9.3		
ZETA 300	400	215.5	56.9	2.2	1.6	213.3	56.4	2.7	2.0	212.2	56.1	5.4	4.0	211.1	55.8	8.1	6.0	210.0	55.5	10.8	7.9	37.0	81.6
	450	242.0	63.9	2.4	1.8	239.3	63.2	3.1	2.3	238.2	62.9	6.1	4.5	237.1	62.6	9.1	6.7	236.0	62.4	12.1	8.9		
	500	268.5	70.9	2.7	2.0	265.3	70.1	3.4	2.5	264.2	69.8	6.8	5.0	263.1	69.5	10.1	7.4	262.0	69.2	13.4	9.9		
	550	295.0	78.0	3.0	2.2	291.3	77.0	3.7	2.7	290.2	76.7	7.4	5.5	289.1	76.4	11.1	8.2	288.0	76.1	14.8	10.9		

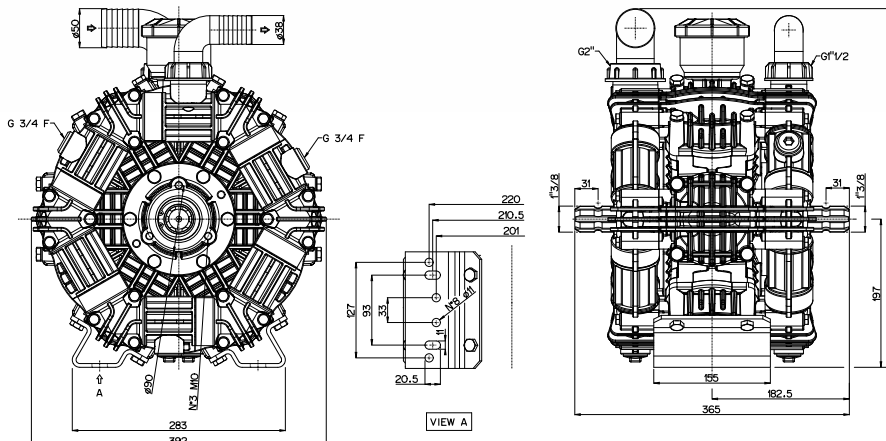

Versioni Versions

Applicazioni Shaft adaptors

MI 1"

ZETA 230 cod. 841500 - ZETA 260 cod. 844100
ZETA 300 cod. 841000

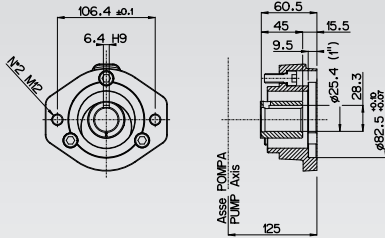
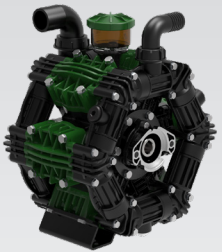

TS 2C

ZETA 230 cod. 849900 - ZETA 260 cod. 849800
ZETA 300 cod. 849600

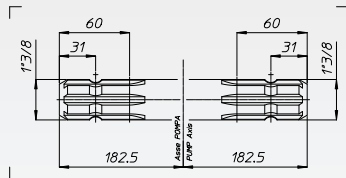
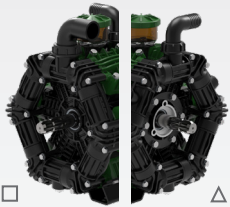

Applicazioni motori idraulici
Shaft adaptors for hydraulic motor

Moltiplicatore
Multiplier

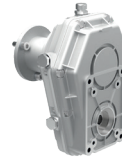

MI Δ

MTP138 Δ

vedi pag 94 see page 94

vedi pag 92 see page 92

Gruppi regolazione pressione Pressure control units

vedi pag 80 see page 80

VRG400

